

# King Pin 3½" – Access from underneath

## KZ1408 – KZ1412

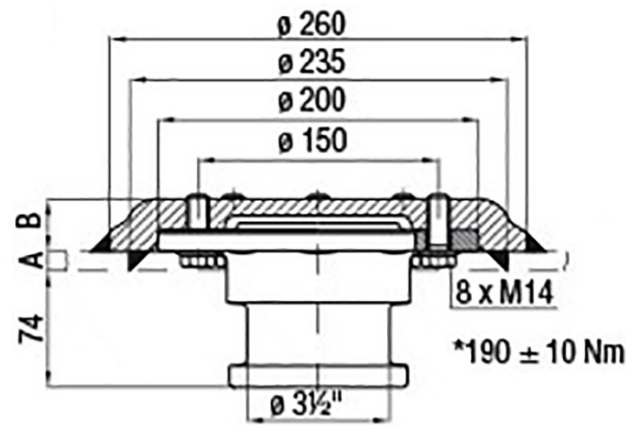

| Skid plate thickness<br>A | Components |                 |          |       |
|---------------------------|------------|-----------------|----------|-------|
|                           | Type       | Retention plate | King pin | CRN   |
| 8mm                       | KZ1408     | KZ100802        | KZ141201 | 24811 |
| 10mm                      | KZ1410     | KZ101002        | KZ141201 | 24811 |
| 12mm                      | KZ1412     | KZ101202        | KZ141201 | 24811 |

Dimensions according to DIN 74083 and ISO 4086  
**JOST** king pins can be used in self steering axle systems.

Mounting must be carried out according to our instructions.

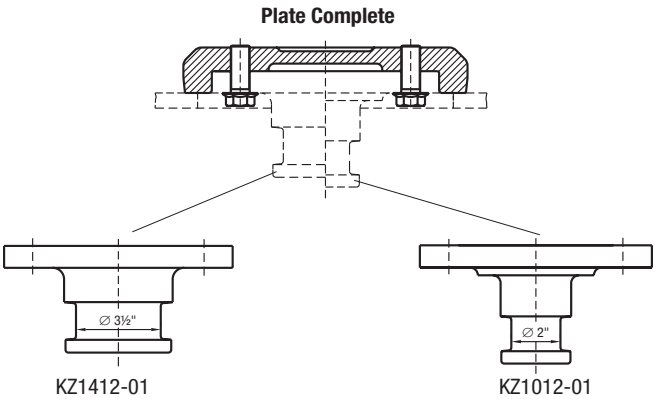

3½" and 2" king pins are easily interchangeable.

### Spare Parts for KZ1408, KZ1410, KZ1412

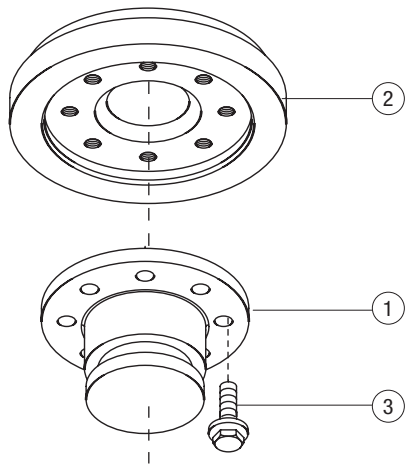

| Fig. | Description                          | Part No.  |
|------|--------------------------------------|-----------|
| 1    | King pin                             | KZ141201  |
| 2    | Retention plate for 8 mm skid plate  | KZ100802  |
| 2    | Retention plate for 10 mm skid plate | KZ101002  |
| 2    | Retention plate for 12 mm skid plate | KZ101202  |
| 3    | Self-securing bolt                   | KZE101203 |