

# Towing eyes 40mm

## ROE57374

Towing eyes according to DIN 74054-40A pressed-in replaceable towing eye sleeve 40 mm inner diameter

Part number	ROE57374
D-value	120kN
CRN	41539
Weight	5kgs
Down load	250kgs

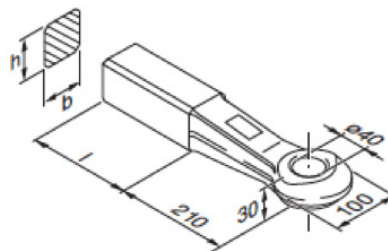

H	B	L
65	57	125

# Towing eyes 50 mm

## ROE57272

Towing eyes according to DIN 74053 pressed-in replaceable towing eye sleeve 50 mm inner diameter

Part no.	<b>ROE57272</b>
Material:	heat-treated steel St 52-3
D-value:	191 kN
Weight:	10.3 kgs
Down Load:	1000 kgs
CRN:	41941

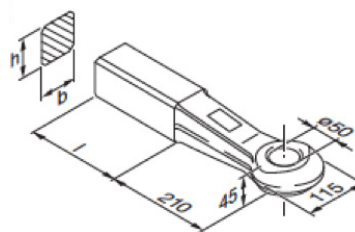

H	B	L
65	60	170

## ROE57005 c/w solid bush

Part no.	<b>ROE57005</b>
Material:	heat-treated steel St 52-3
D-value:	314kN
Weight:	13.4 kgs
Down Load:	1000 kgs

D-value is reduced to 190kN with 100 kgs down load.

CRN: 49663

